



3 Corr Grove MELTON VIC

4 2 1

Upon entering this great family home, you will instantly feel the ample space and comfort on offer with a block of 936m² (Approx)!

Comprising of 4 large bedrooms to accommodate the whole family (main bedroom comes complete with modern ensuite and walk in robe), well-equipped kitchen and adjoining dining, extremely spacious living zone, a separate rumpus room with outdoor views and a bright central bathroom including bath to service remaining bedrooms - this unique, spacious and functional floor plan truly has it all.

Moving outside, this amazing family home is further complimented by a stunning outdoor entertaining area featuring a large pergola for socialising and dining no matter the season, as well as low maintenance gardens

Land Size : 936 sqm
View : <https://www.ypa.com.au/7399309>



Shane Spiteri
0488 980 115

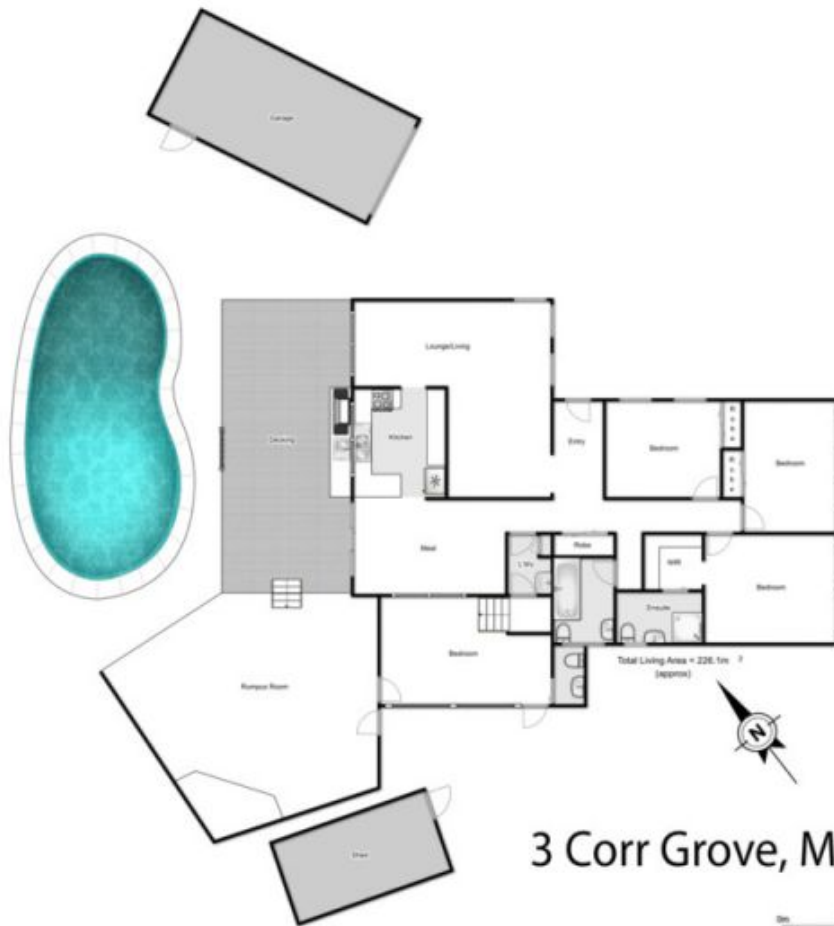

3 Corr Grove, Melton

0m 2m 4m 6m 8m

Whilst every attempt has been made to ensure the accuracy of the floor plan contained here, measurements of doors, windows, rooms and any other items are approximate and no responsibility is taken for any error, omission, or misstatement. This plan is for illustrative purposes only and should be used as such by any prospective purchaser. The services, systems and appliances shown have not been tested and no guarantee as to their operability or efficiency can be given.

