



21 Turpentine Road BROOKFIELD VIC

4 2 2

Investors take note.

Behind the classy modern facade, this light filled home will surprise at every turn.

Providing four great size bedrooms (master with full ensuite & WIR), and well-designed kitchen with quality stainless steel appliances that overlooks the family/ meals area. Set on a great size allotment with a long list of inclusions from gas ducted heating, cooling, double garage with internal and drive through access..

Currently tenanted at until June 2018 at \$320 per week, this will make the perfect addition to your investment folio.

Inspections are truly our pleasure, call today to arrange your viewing!

Land Size : 439 sqm

View : <https://www.ypa.com.au/7399344>



Shane Spiteri
0488 980 115

21 Turpentine rd, Brookfield

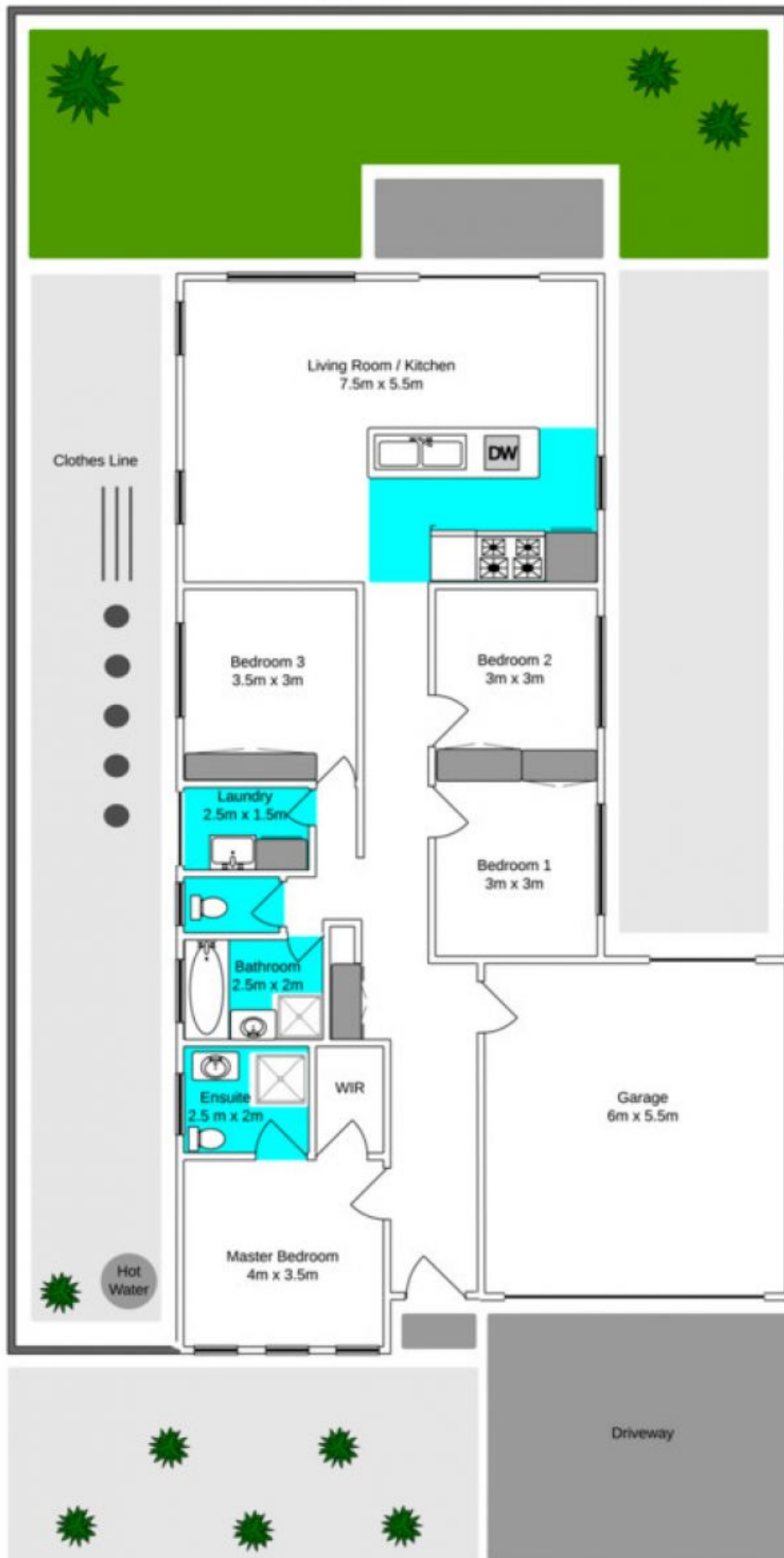

Whilst every precaution has been taken to establish the accuracy of the above information, Prospective buyers are advised to make their own enquiries.

