



## 5 Hildegard Court BROOKFIELD VIC

6 3 3

This stunning Victorian dual-family residence, positioned on a huge allotment of 2,000m<sup>2</sup> (approx.) provides a rare and unique opportunity for one lucky buyer. This beautiful home is strategically positioned in Brookfield close to schools, shops and public transport. From the very moment you walk through the doors and take in the flowing floor plan, this beautiful property will have you captivated.

Entering this warm and inviting home you are greeted by space, style and comfort that only limited homes can offer. The main dwelling consists of four large bedrooms, master bedroom boasting large ensuite with corner spa bath and walk in robe, whilst the remaining bedrooms are serviced by a bright central bathroom.

Space to relax and entertain is sorted with multiple living zones, including large formal lounge upon entry, additional

**Land Size** : 2000 sqm

**View** : <https://www.ypa.com.au/7399657>



**Shane Spiteri**  
0488 980 115

# 5 Hildegarde Court, Brookfield

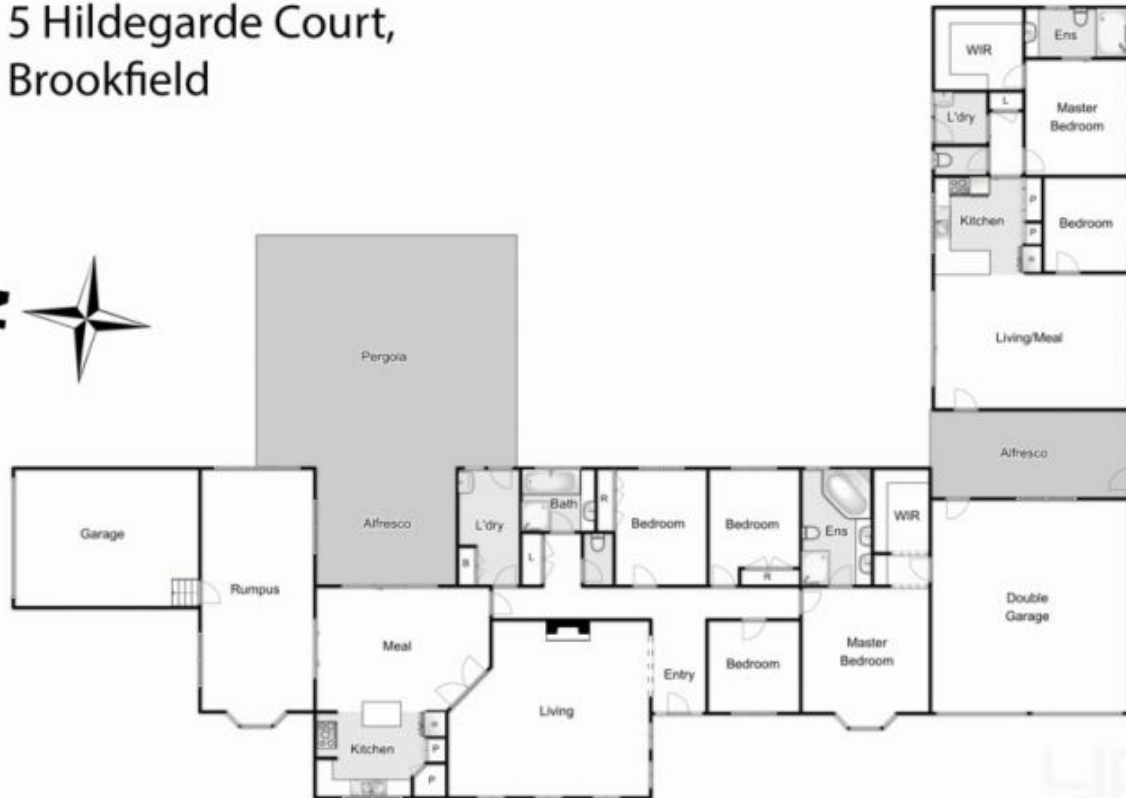

Whilst every attempt has been made to ensure the accuracy of the floor plan contained here, measurements of doors, windows, rooms and any other items are approximate and no responsibility is taken for any error, omission, or mis-statement. This plan is for illustrative purposes only and should be used as such by any prospective purchaser. The services, systems and appliances shown have not been tested and no guarantee as to their operability or efficiency can be given.