



## 1/2 Phillip Street Rosebud VIC

2 1 1

Nestled peacefully on a quiet street and one of only three quality residences occupying the block, this gorgeous two bedroom single level home offers a lovely open design with each room enjoying an abundance of natural light.

**Price** : \$ 680,000

**View** : <https://www.ypa.com.au/7834624>

Quality inclusions feature throughout the property and include plantation shutters, a modern kitchen and bathroom, a lovely undercover entertaining space and courtyard, light neutral flooring (carpet and tiles), plus all of the creature comforts one would expect such as gas ducted heating, split system air conditioning, quality appliances, and a single lock up garage.

Surrounded by lush gardens and offering a lifestyle unlike any other, from this location you are a mere 450\*m to the foreshore and McCrae Plaza, plus just 350\*m to the Mornington Peninsula Freeway on ramp, and just a short



**Ben Nutbean**  
0413 125 996



**Jade Springer**  
0437 410 791

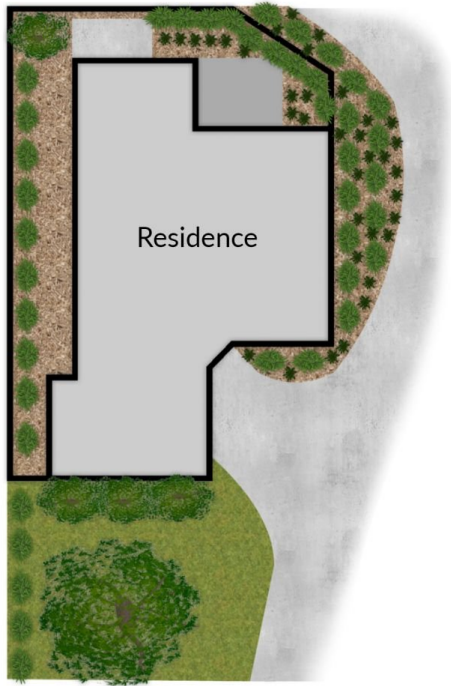

# 1/2 Phillip Street Rosebud

Total Internal Area 129sqm Approx

All Plans are an artistic representation and should not be relied on. 3D Plans will contain elements that do not exist and are for inspiration only. All measurements, dimensions and illustrated areas are approximate. This Plan has No Warranty and it is the responsibility of all interested parties to verify all data depicted and omitted  
 Marshall Commercial Photography 0410 591 779 petemars@bigpond.com