



1/6 Railway Road Cheltenham VIC

1  1  1 

This apartment showcases functionality, vibrancy, and an excellent use of space. The living/kitchen area comes to life immediately as you walk through the front door, with an open plan design leading through to the spacious main bedroom with built in robes.

Positioned right in the heart of Cheltenham just off Charman Rd, this stunning 1-bedroom apartment is sure to impress located just few minutes' walk to Cheltenham Train Station, 10 min walk to the fashionable Westfield Southland, 5 min walk to Cheltenham Park Reserve & Playground, 10 minutes to Half Moon Bay Beach/Blackrock Beach & Sandringham Beach, 5 min walk to Cheltenham Primary and childcare, shops, cafes, supermarkets, places of worship are all within minutes walking distance.

A courtyard/balcony area which is accessible from the

View : <https://www.ypa.com.au/7877443>



Bassam Tofaili
0477 972 229

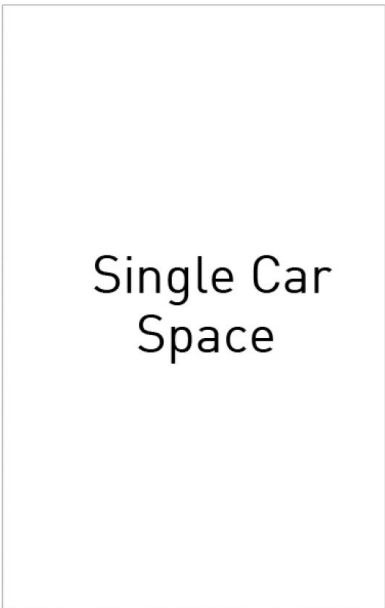
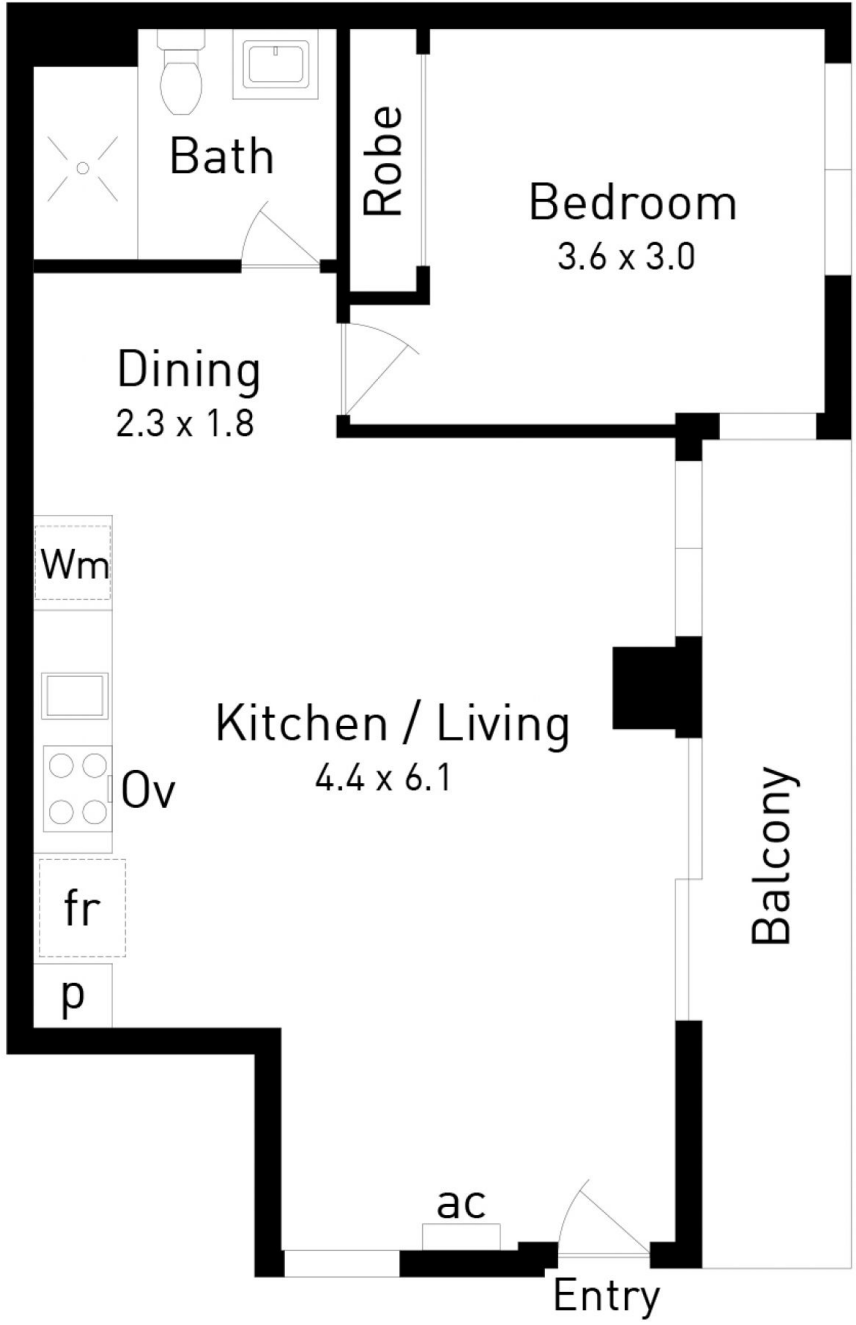

(Not In Position)

Internal 45m² | Balcony 6m² ← N

G1/6 Railway Road, Cheltenham



Disclaimer: Please note this floor plan is for marketing purposes and is to be used as a guide only. This floor plan is intended to give a general indication of the layout only. Any statements of distance, size or area are approximate and for indicative purposes only.