



40 Wondaree Street Rye VIC

3 1 2

YPA Rye Rental Department is Proud to present this Beautifully updated property.

Land Size : 640 sqm

View : <https://www.ypa.com.au/7916790>

Featuring

- Sunny east-facing aspect.
- Beautifully updated interiors.
- Three generous bedrooms (all with BIR's)
- Renovated bathroom featuring floor to ceiling tiles, frameless shower screen, rain shower head, and modern vanity.
- Double carport.
- Undercover patio and gazebo.
- Firepit.
- Set on a fantastic allotment of approximately 640*m2.
- Located just minutes to Rye Village and foreshore.



Jessica Trahar
0416 737 904

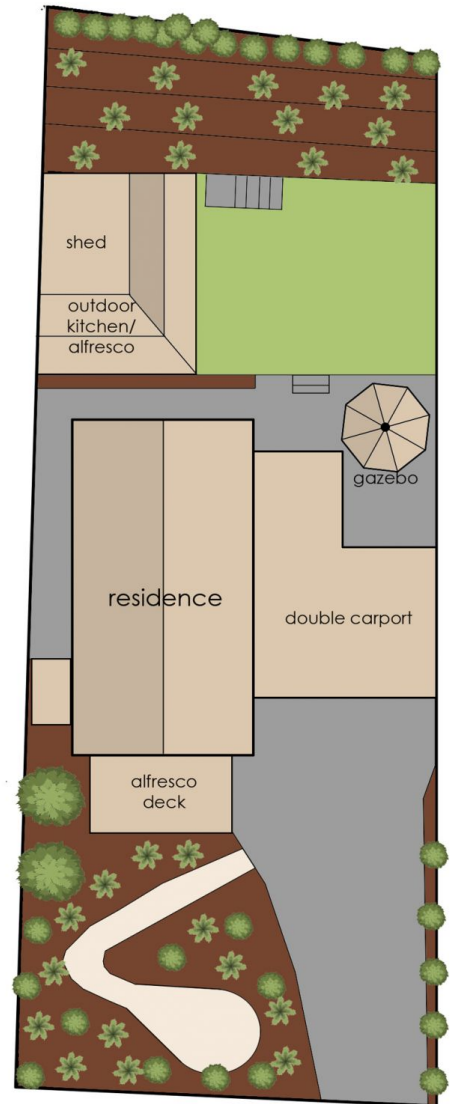

40 Wondaree Street, Rye

This floorplan is for illustration purposes only and no warranty is given to its accuracy. Purchasers are advised to carry out their own investigations.