



## 142 Sterling Drive Keilor East VIC

4 1 2

There is lots to love about living here...especially for families. A welcoming street appeal, beautifully positioned in a thriving suburb away from all the hustle and bustle on perfectly rectangular 535m<sup>2</sup> (approx.) block.

But not only location ...this solid brick home has been superbly renovated and embodies a convenient lifestyle, impeccably presented with low-maintenance front and rear gardens, making this a perfect choice for home buyers or investors.

The elevated porch entry makes way into the home featuring hardwood floors, square set doorways and wall cut-out features, warm and inviting with all the hard work done, all you need to do is move in, sit back and relax. You'll love the 4 bedrooms with clever open designed tailored wardrobes.

**Price** : \$ 745,000  
**Land Size** : 539 sqm  
**View** : <https://www.ypa.com.au/7924352>



**Michael Sassine**  
0421 023 243

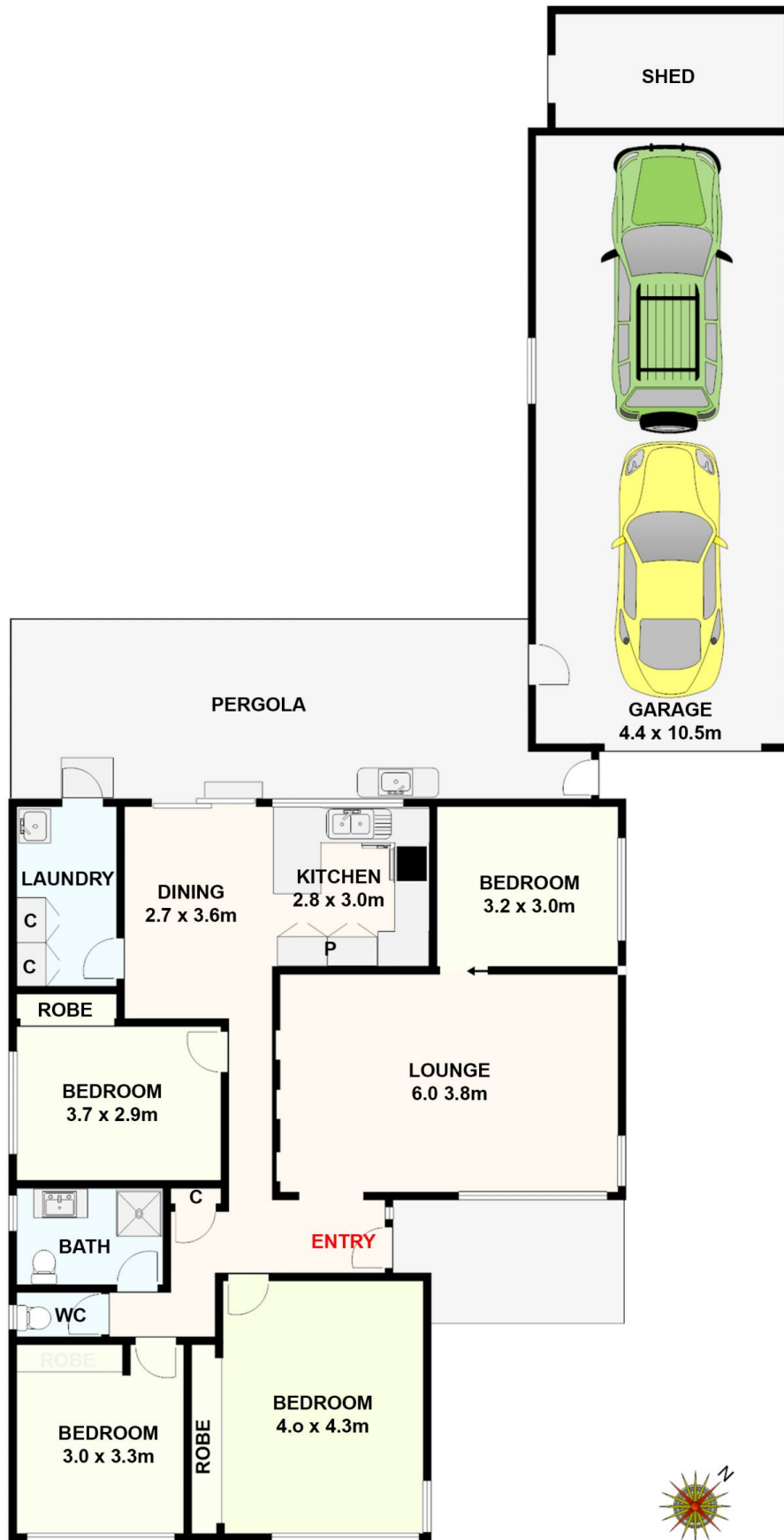

**142 Sterling Drive, Keilor East.**

*All data and dimensions shown in this sketch are approximate.*