



23 Etheridge Rise Caroline Springs VIC

3 2 2

This architecturally owner built family domain will be at the top of your dreams list! Behind an appealing facade and situated in a beautiful street, this home surely hits all the high notes for you and your growing family! Built to last a lifetime there is something for a family of all ages to enjoy, you will fall in love with the feeling this home has.

Features Include:

- ? Master bedroom showcasing a ceiling fan, walk-in wardrobe and ensuite with double vanity, caesar stone bench top and quality fittings
- ? Additional two spacious bedrooms with built-in wardrobes and ceiling fans
- ? Open plan kitchen is located perfectly to incorporate the large meals and living space with ceiling fans
- ? Kitchen complete with plumbing behind the fridge, caesar stone bench tops, ample cupboard space, electric cook top,

Price : \$ 750,000
Land Size : 448 sqm
View : <https://www.ypa.com.au/7927922>



Andrew Migliorisi
0432 526 844



Stephen Azzopardi
0402 012 554

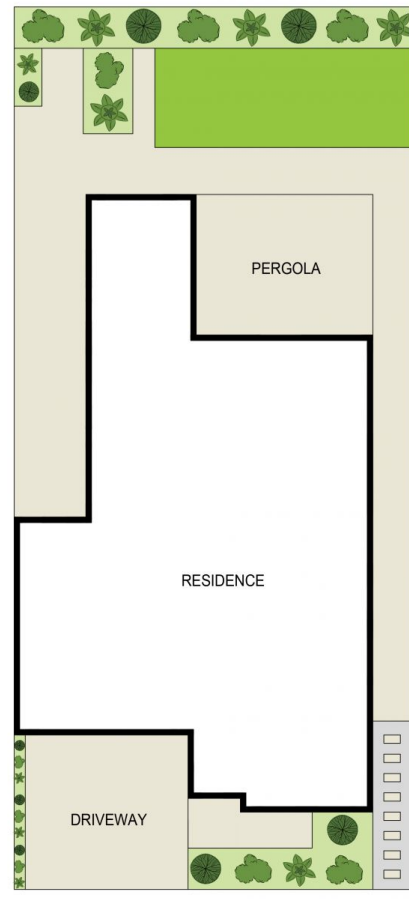

SITE PLAN
(NOT TO SCALE)

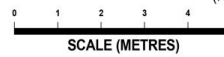

23 Etheridge Rise, Caroline Springs

DISCLAIMER : ALL DIMENSIONS ARE AN APPROXIMATION ONLY AND NO GUARANTEE IS GIVEN WITH RESPECT TO ACCURACY.