



## 32 Strathmore Crescent Hoppers Crossing VIC

3 1 2

We are delighted to present this rare opportunity to own a stunning home in a prime location. Just a short walk from the vibrant Pacific Werribee retail and entertainment hub, this beautiful property offers the perfect blend of comfort, convenience, and potential.

Step inside and discover three spacious bedrooms, each with built-in robes, providing ample storage and a cozy retreat for everyone in the family. The heart of the home is the expansive open kitchen, ideal for culinary adventures and family gatherings. The adjoining dining area is perfect for both casual meals and special occasions.

Designed with practicality in mind, the two-way bathroom ensures accessibility and functionality for the entire household. The property features two distinct living areas, including a charming step-down lounge, offering versatile

**Price** : \$ 566,000  
**Land Size** : 562 sqm  
**View** : <https://www.ypa.com.au/8023030>



**Abdul Merabi**  
0424 263 506



**Mitch Smit**  
0450 913 513

# 32 Strathmore Crescent, HOPPERS CROSSING

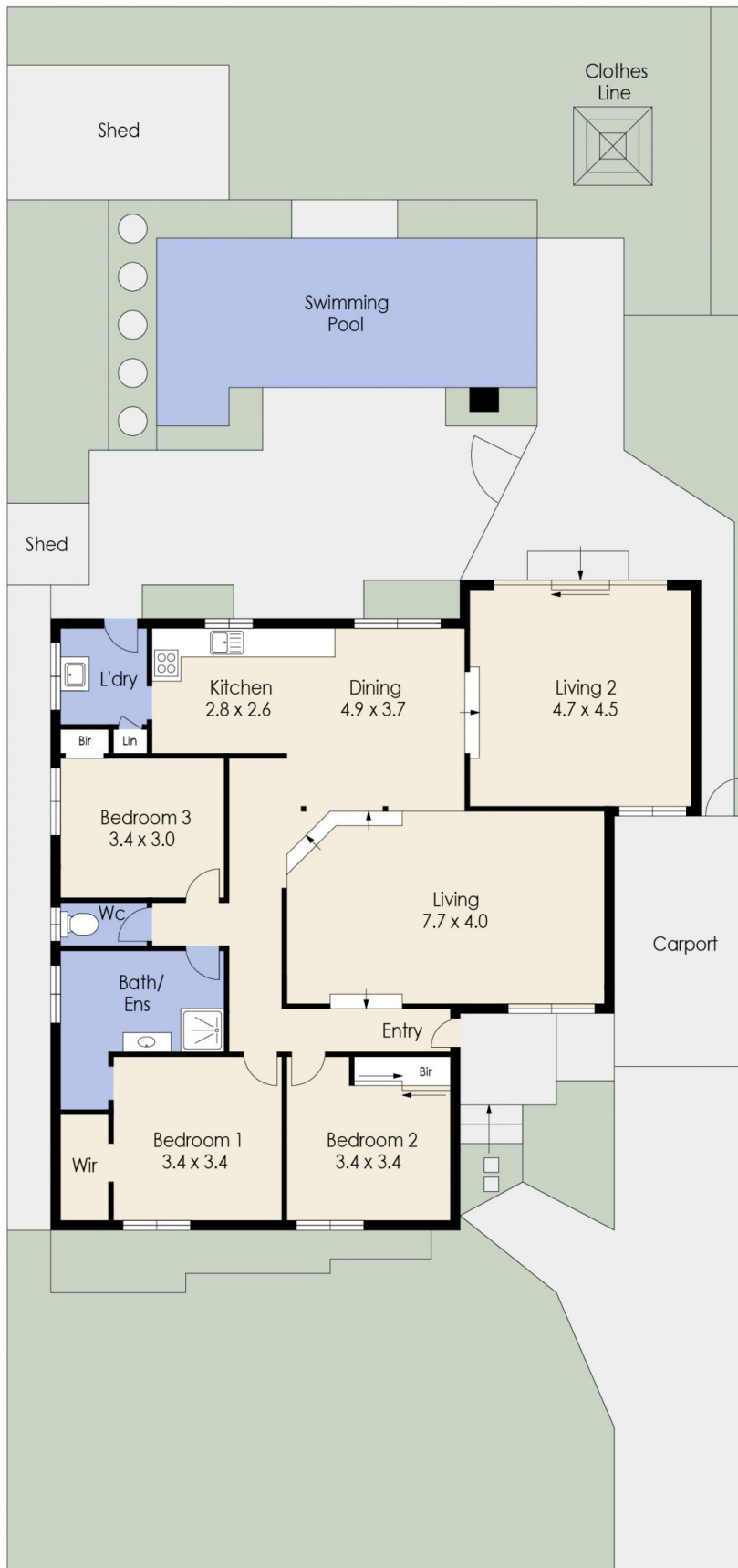

Whilst every attempt has been made to ensure the accuracy of the floor plan contained here, measurements of doors, windows, rooms and any other items are approximate and no responsibility is taken for any error, omission, or mis-statement. This plan is for illustrative purposes only and should be used as such by any prospective purchaser. The services, systems and appliances shown have not been tested and no guarantee as to their operability or efficiency can be given.