



13 Switch Street Clyde VIC

4 2 1

Step into your future with this incredible contemporary 4-bedroom, 2-bathroom home. Elevate the everyday with modern inclusions and spacious interiors for the whole family to enjoy. The highlights include an open-plan central living zone, an expansive alfresco, a beautifully landscaped garden, and a sophisticated master suite.

You are welcomed by a bright and spacious central living room that instantly draws you in. With sleek modern features, neutral tones and rays of natural light flooding this space, it offers the perfect relaxation zone for the entire family. The kitchen is a chef's delight with stone countertops, a breakfast bar, and high-quality stainless-steel appliances, including dishwasher. It opens on to the gorgeous lounge and formal dining zone that seamlessly connect to the outdoors through large sliding doors. An inviting alfresco area makes for intimate outdoor

Price : \$ 630,000
Land Size : 238 sqm
View : <https://www.ypa.com.au/8030726>



Vijay Kumar
0431 177 566



Rajiv Ranjan
0413 775 214

Floor Plan

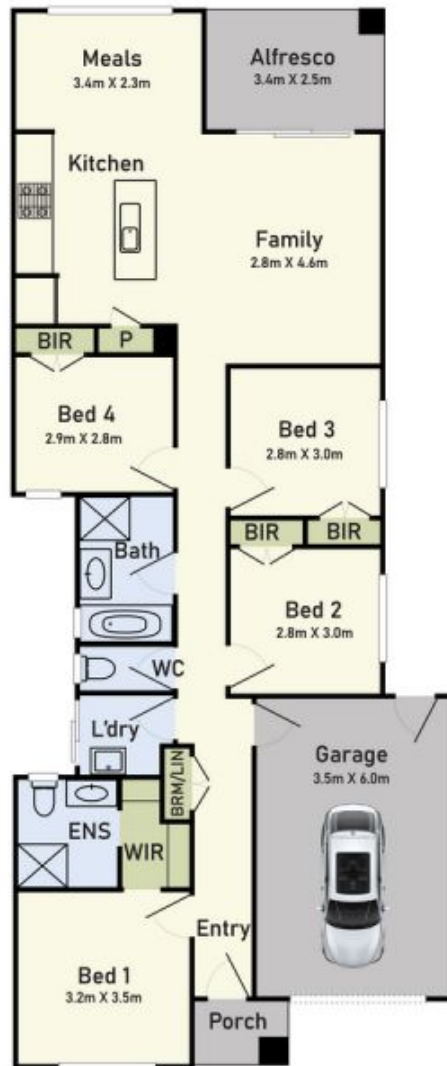

Site Plan



13 Switch Street, Clyde, VIC 3978



* Dimensions are approximate and for illustrative purposes only