



1 Hillview Avenue Rye VIC

3 1 2

Situated in a convenient yet quiet location, this well maintained three bedroom brick veneer residence sits on a generous, level corner block spanning approximately 700 sqm and offers a tranquil haven just moments away from the pristine shores of Port Phillip Bay and Rye village.

Recently renovated and with nothing to do except unpack your bags and start enjoying the good life, this beautiful home offers a new roof, new decking, and outdoor shower. The light filled interiors also offer a brand new bathroom, new flooring, sheer curtains, modern fixtures, gas log fire, and a new hot water unit.

The kitchen, equipped with quality appliances, ensures functionality and convenience, while ample parking adds to the property's practical appeal. With its convenient location and promising prospects, this property serves as an ideal

Price : \$ 780,000
Land Size : 686 sqm
View : <https://www.ypa.com.au/8030983>



Jade Springer
 0437 410 791



Kelsie Janssen
 0417 245 204

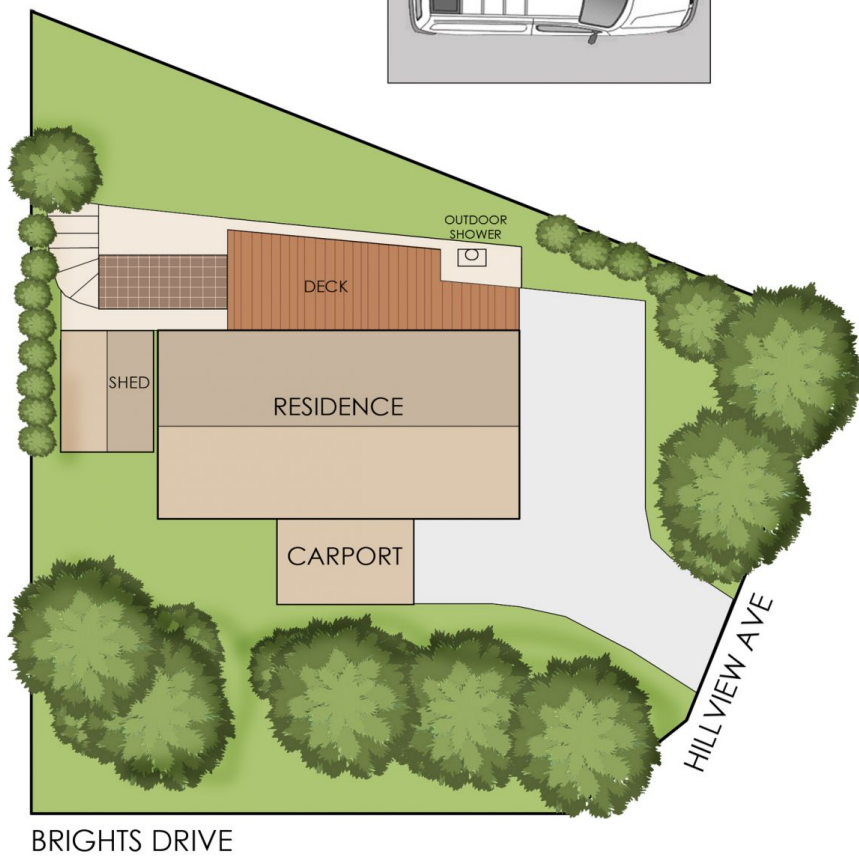

1 Hillview Avenue, Rye

© Produced by DND Floor Plans

This floorplan is for illustration purposes only and no warranty is given to its accuracy. Purchasers are advised to carry out their own investigations.