



10 Thompson Court Werribee VIC

4  2  4 

YPA Point Cook proudly present this lavish and extravagant property spans an impressive 1451 sqm of land in the thriving west Melbourne suburb of Werribee, just 25 kilometers from the CBD. Nestled in an esteemed locale renowned for its parklands, wetlands, and easy access to amenities, this home offers unparalleled convenience and lifestyle.

The meticulously designed house features an ornate facade that sets the tone for luxurious living. Inside, discover a meticulously planned interior boasting four spacious bedrooms with ample built-in wardrobes, including a cozy upstairs retreat with a separate study or teenager's haven. The heart of the home is a kitchen that combines elegance with functionality, perfect for culinary enthusiasts.

Price : Under Offer
Land Size : 1451 sqm
View : <https://www.ypa.com.au/8042754>



Cassandra He
0422 669 386



Nirav Gupta
0452 236 536

GROUND FLOOR



SITE PLAN

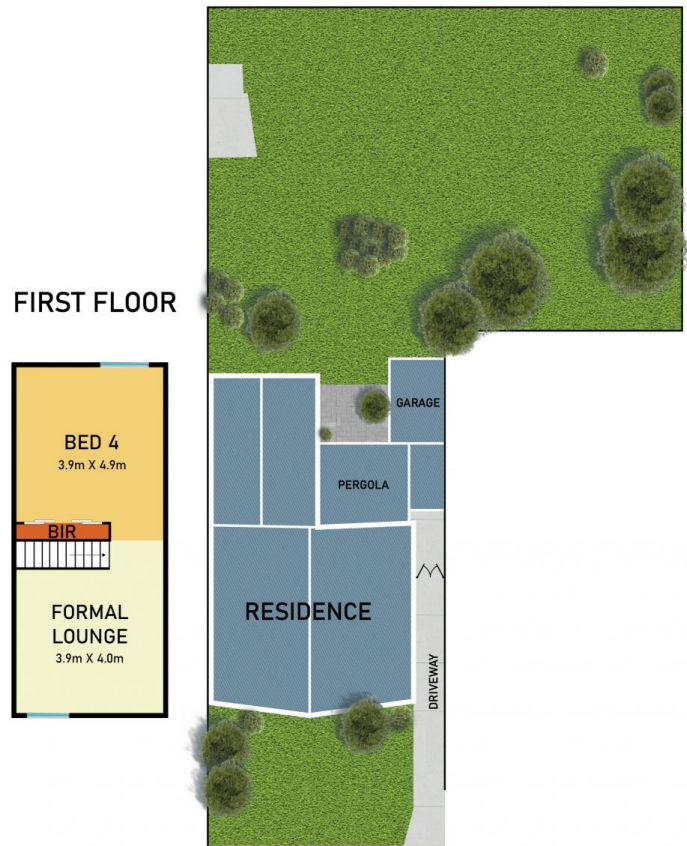

10 THOMPSON COURT, WERRIBEE

* Dimensions are approximate and for illustrative purposes only