



## 1 Drouin Court MELTON SOUTH VIC

3 1 2

Situated in the sought pocket of Melton South boasting a whopping 627m<sup>2</sup>(approx.) block, this property sits in close proximity to all amenities including: Coburns Primary School, Melton Christian College, Freeway access, Melton Train Station, bus stops, parks and so much more, this property is the perfect opportunity for all buyers entering the property market, families and investors alike.

Upon entering this warm and welcoming domain you are greeted by the beautiful massive lounge room boasting an open fireplace, making this the perfect place for the family to gather and enjoy movie nights or wind down after work!

The lounge room flows through to the dining space perfect to host family dinners. The beautiful kitchen has been tastefully updated showcasing a laminate benchtop, updated gas cooktop & electric oven, tiled splashback,

**Price** : \$ 489,000

**View** : <https://www.ypa.com.au/8043077>



**Ryan Anders**  
0434 900 300

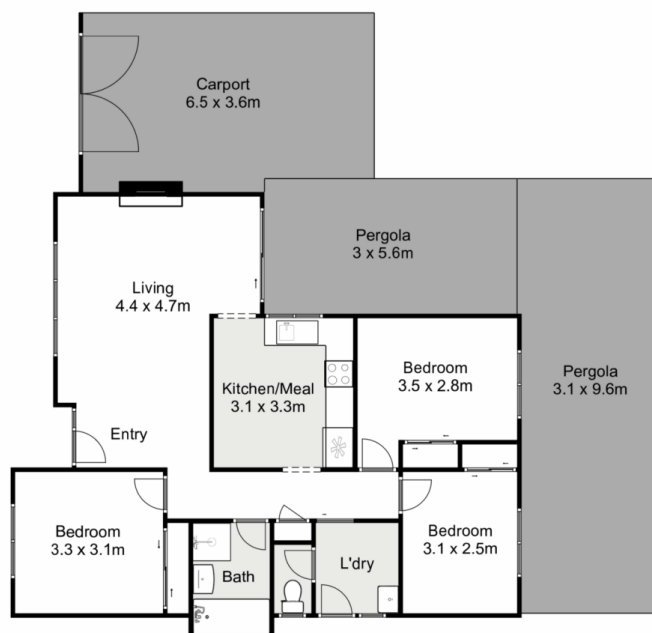

## 1 Drouin Court, Melton South

ypa

Whilst every attempt has been made to ensure the accuracy of the floor plan contained here, measurements of doors, windows, rooms and any other items are approximate and no responsibility is taken for any error, omission, or mis-statement. This plan is for illustrative purposes only and should be used as such by any prospective purchaser. The services, systems and appliances shown have not been tested and no guarantee as to their operability or efficiency can be given.

