



## 14 Evelyn Close MELTON WEST VIC

3 1 2

Situated on a large 735m<sup>2</sup> (approx.) parcel of land, this stunning home has been meticulously cared for by its current owners, making it the perfect opportunity to move straight in. Located in a highly sought after pocket in Melton West close by to all levels of schooling, childcare and preschool centres, parks, freeway access, and only a short walk to Woodgrove Shopping Centre, the positioning of this home is hard to beat.

Upon entering, you are welcomed by the expansive living area, offering ample space for the family. This space features a fireplace and ceiling fan, enhanced by ducted heating and evaporative cooling throughout the entire home. The open floorplan seamlessly integrates a meals area, overlooked by a stunning kitchen equipped with stainless steel appliances, a dishwasher, gas cooktop, pendant lighting, and abundant natural light.

**Price** : \$ 520,000  
**Land Size** : 735 sqm  
**View** : <https://www.ypa.com.au/8048168>



**Ricky Frew**  
**0402 007 100**

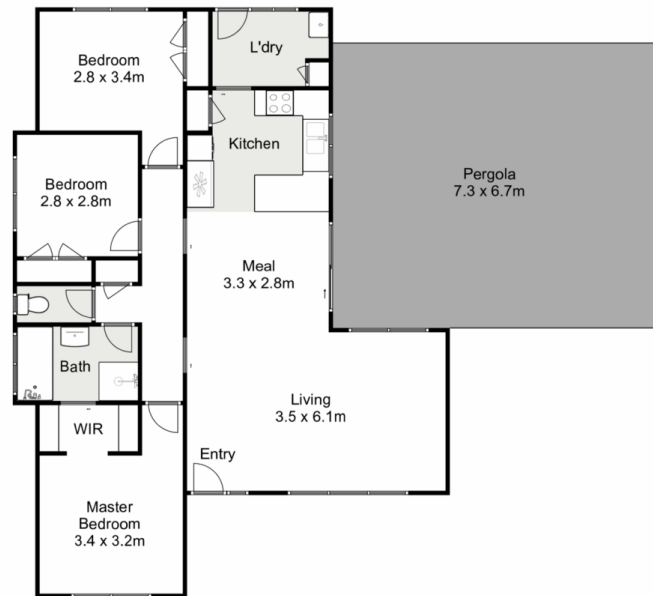

## 14 Evelyn Close, Melton West

ypa

Whilst every attempt has been made to ensure the accuracy of the floor plan contained here, measurements of doors, windows, rooms and any other items are approximate and no responsibility is taken for any error, omission, or mis-statement. This plan is for illustrative purposes only and should be used as such by any prospective purchaser. The services, systems and appliances shown have not been tested and no guarantee as to their operability or efficiency can be given.

