



## 6 Pendower Way Werribee VIC

3 2 2

This Brand-New SOHO built townhouse is positioned in the thriving Harpley Estate surrounded by waterways, lakes and walking/bike tracks. This home is a perfect start for any young family or a very smart investment opportunity with a low maintenance lifestyle provided.

The family friendly community proposes a new Kindergarten & Community Centre, a Catholic Primary School, a Town Centre with cafes, restaurants and future planning for a, local medical facilities, gyms and retail outlets to provide ample shopping opportunities in the near future!

Only a 10-minute drive to Werribee CBD & two Train Stations, walking distance to established schools, kindergarten and childcare facilities, you are within close proximity to many shopping centres and local transport.

**Price** : \$ 520,000  
**Land Size** : 156 sqm  
**View** : <https://www.ypa.com.au/8069216>



**James Christou**  
**0450 733 302**



**Mitch Smit**  
**0450 913 513**

# 6 Pendower Way, WERRIBEE

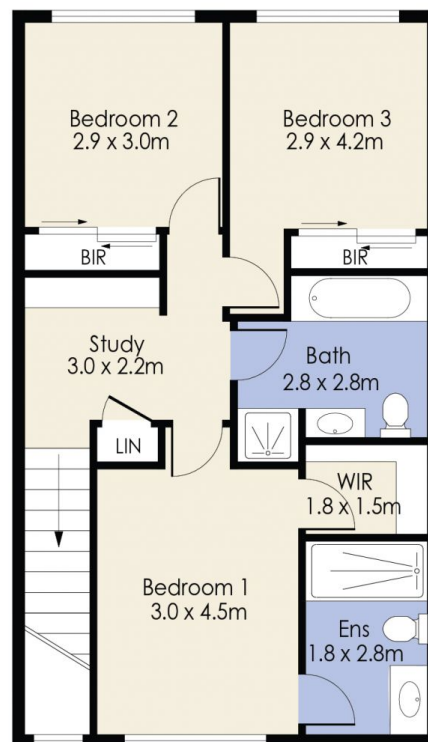
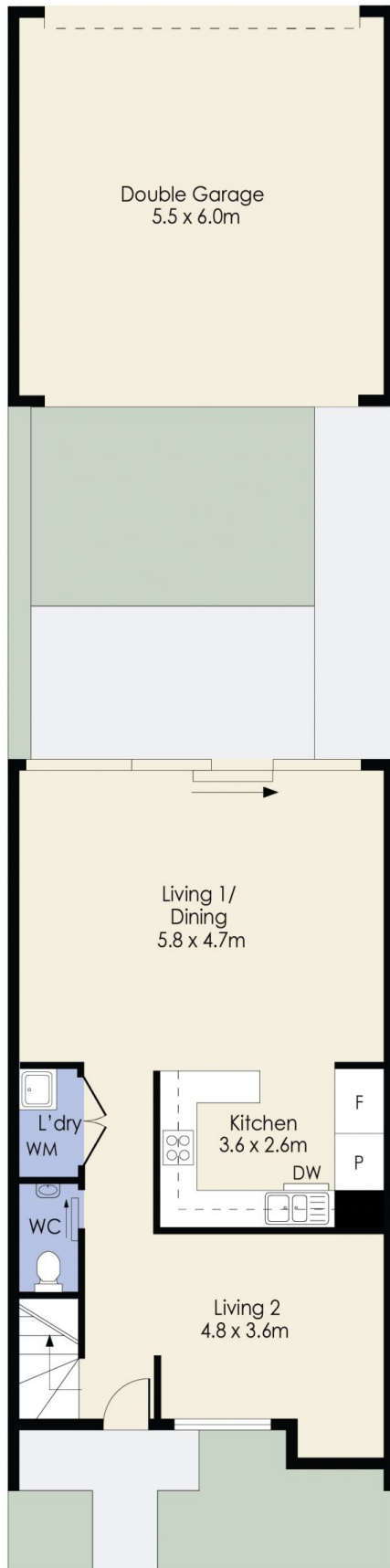

Whilst every attempt has been made to ensure the accuracy of the floor plan contained here, measurements of doors, windows, rooms and any other items are approximate and no responsibility is taken for any error, omission, or mis-statement. This plan is for illustrative purposes only and should be used as such by any prospective purchaser. The services, systems and appliances shown have not been tested and no guarantee as to their operability or efficiency can be given.