

## 51 Astley Wynd Lynbrook VIC

4 2 2

Discover unparalleled comfort and accessibility in this spacious, purpose-built home. Thoughtfully designed with no steps and efficient layout, this residence is perfect for individuals with disabilities or anyone looking for a versatile, expansive living space.

Key features include:

- Two Expansive Bedrooms: Both bedrooms feature room-sized, wheelchair-accessible ensuites, providing ample space and convenience. Two additional well sized bedrooms cater for the remaining family members.
- Multiple Living Areas: Enjoy two generous living spaces, including a sunroom equipped with a gas and solar-heated hydrotherapy pool, ideal for relaxation and therapy.
- Large Central Kitchen: A culinary haven, the kitchen boasts two electric fan-forced ovens, two dishwashers, a

**Price** : \$ 860,000  
**Building Size** : 215 sqm  
**Land Size** : 608 sqm  
**View** : <https://www.ypa.com.au/8070536>



**Frances Cutri**  
**0423 485 688**

**Vikram Chandel**  
**0430 055 933**

Floor Plan



Site Plan

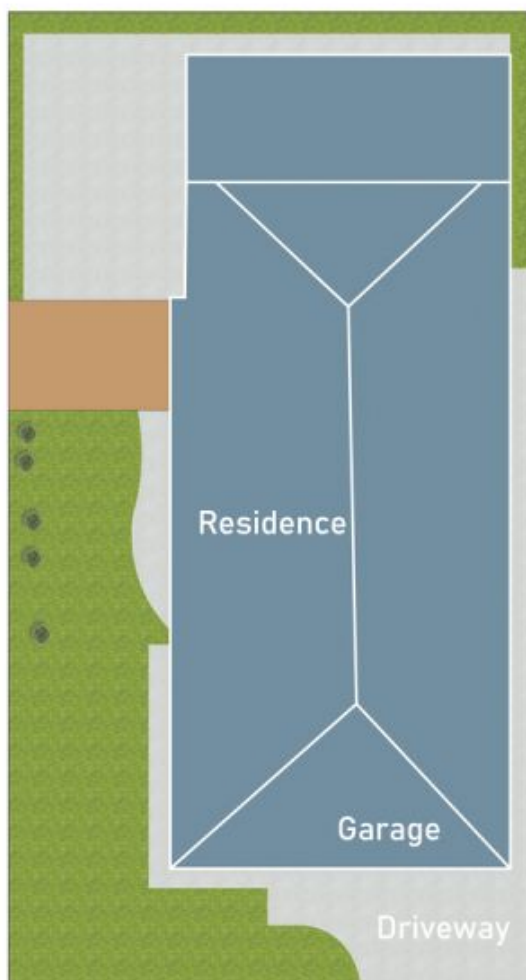

51 Astley Wynd, Lynbrook, VIC 3975

\* Dimensions are approximate and for illustrative purposes only