

14 Flaxseed Drive Mickleham VIC

3 2 2

Welcome to your perfect retreat in the heart of Mickleham! This stunning 3 bedroom, 2 bathroom, 2 car garage house is a sanctuary of modern comfort and style.

Price : \$ 605,000

View : <https://www.ypa.com.au/8081032>

Discover the epitome of contemporary living with this stunning property that boasts an array of impressive features. Step into a spacious interior flooded with natural light, where every room is thoughtfully designed for functionality and style.

The gourmet kitchen is a chef's dream, equipped with stainless-steel appliances, sleek countertops, and ample storage space. Retreat to the luxurious master suite offering a private sanctuary with a spacious bedroom, elegant ensuite bathroom, and a walk-in closet, as well as 2 additional bedrooms. Outside, enjoy a beautifully landscaped yard perfect for outdoor entertaining or relaxing



Asad Khan
0400 008 881



George Chammas
0466 355 554

Floor Plan

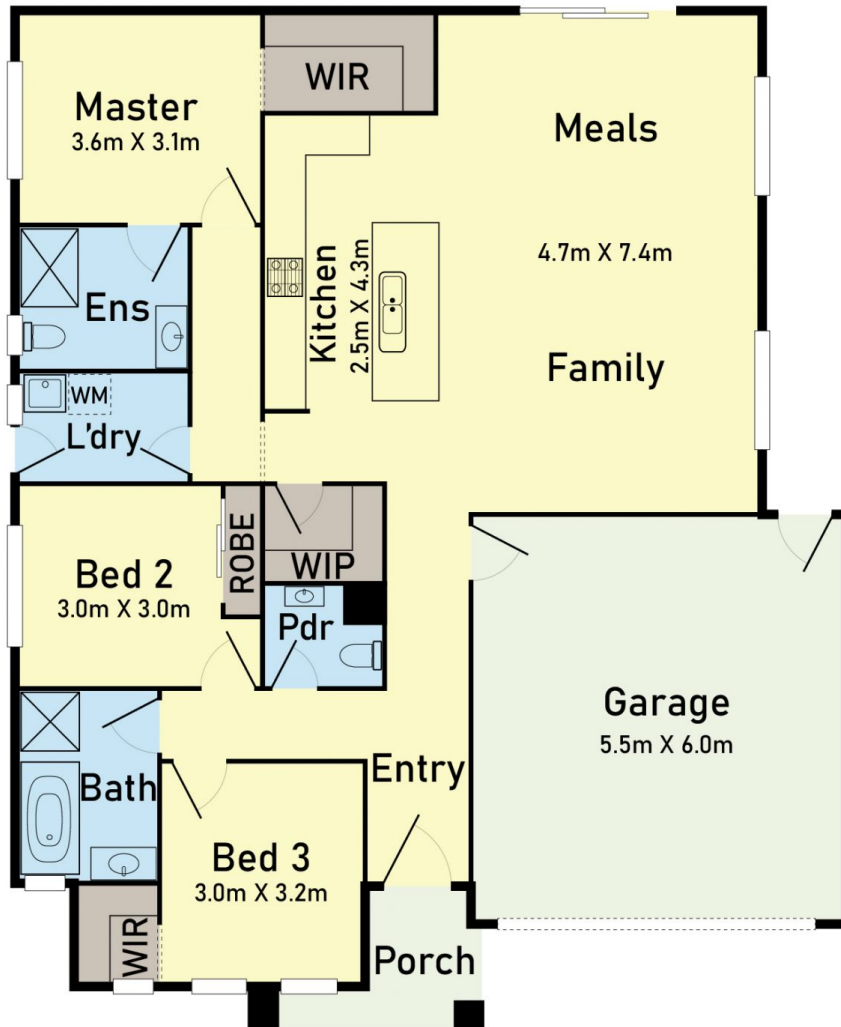

14 Flaxseed Drive, Mickleham
