

68 Grevillea St Craigieburn VIC

4 2 1

Welcome to 68 Grevillea St, Craigieburn, where modern elegance meets family-friendly living. This beautifully presented home is perfect for those seeking comfort, convenience, and a touch of luxury.

Price : Private Sale - \$580,000 - \$630,000
Land Size : 322 sqm
View : <https://www.ypa.com.au/8091360>

Key Features:

? **Spacious Living Areas:** Enjoy the open-plan living and dining spaces, perfect for family gatherings and entertaining guests.

? **Gourmet Kitchen:** Featuring high-quality appliances, ample storage, and a stylish island bench, this kitchen is a chef's dream.

? **Master Suite:** Relax in the generous master bedroom with a walk-in robe and a luxurious ensuite bathroom.



Manu Kumar
0435 456 004



Carla Primiano
0407 183 331

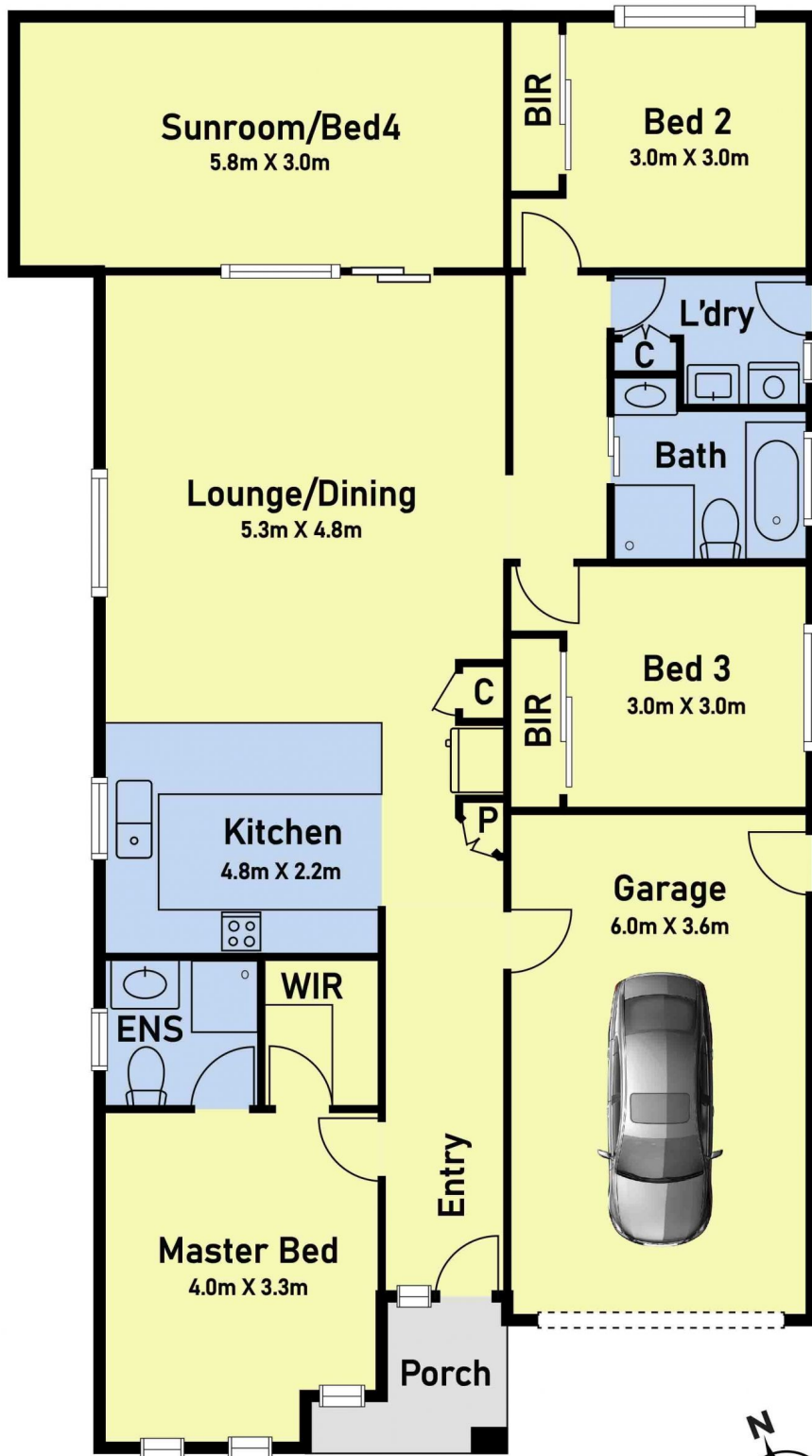

NOTE: SIZE AND DIMENSIONS ARE INDICATIVE AND SHOULD NOT BE TAKEN AS DEFINITE.