



16 Coobowie Dr Doreen VIC

4 2 2

Stunning Tri-Level Home with exceptional views

Overview:

Discover your dream home in the heart of Laurimar! This exquisite, near new, tri-level property offers an unparalleled living experience with its stunning facade and meticulously designed interior and exterior spaces. Set on a 525m² block, this home boasts classic whites and neutral tones that exude warmth and comfort throughout.

Key Features:

- Breathtaking Views: Elevated position overlooking Laurimar and offering picturesque views across the suburb and beyond, including the twinkling lights at night.

Price : \$1,080,000 - \$1,180,000
Land Size : 525 sqm
View : <https://www.ypa.com.au/8093498>



Carla Primiano
0407 183 331



Manu Kumar
0435 456 004

Ground Floor

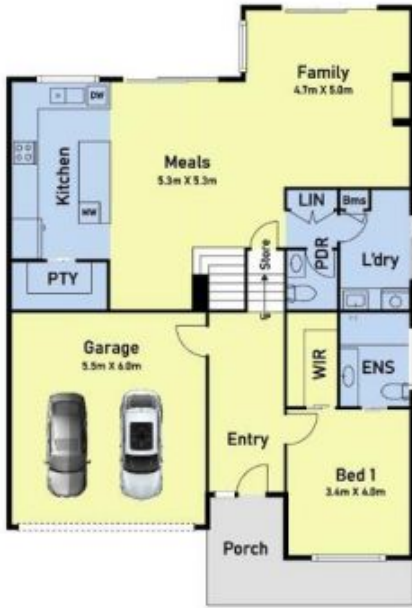

First Floor



Site Plan



NOTE: SIZE AND DIMENSIONS ARE INDICATIVE AND SHOULD NOT BE TAKEN AS DEFINITE.