



## 12 Sacred Drive Sunbury VIC

4  3  2 

Situated in the prestigious Redstone estate on a 448m2 (approx.) block size this Henley built home is the one for you. Just a short stroll from the local park this home is waiting for its next fortunate owners. You'll be captivated by the timeless elegance and thoughtful design that define this home from the moment you look at the facade.

Upon entering inside, you are welcomed into a space that exudes sophistication and warmth. The open-plan layout seamlessly integrates with the luxurious kitchen, which boasts Caesarstone benchtops, an induction cooktop, and a walk-in butler's pantry, ample bench and cupboard space. This space is filled with so much natural lighting, giving a bright and homey feel. A large dining area for the family to gather and a large family living space which offers indoor-outdoor flow by the expansive sliding stacker doors, leading to a spacious decked alfresco area. This outdoor

**Price** : \$890,000 - \$960,000  
**Land Size** : 448 sqm  
**View** : <https://www.ypa.com.au/8112364>



**Patrick Kilkenny**  
0401 175 248



**Cassandra Doria**  
0497 972 028

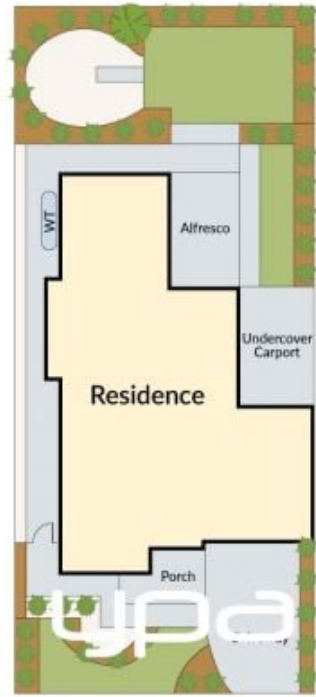

**Disclaimer:** All information contained herein is gathered from sources we believe to be reliable. However we cannot guarantee its accuracy and interested persons should rely on their own enquiries. Dimensions are approximate.