

13 Sunningdale Road Rosebud VIC

4 2 3

Located on a highly sought-after street bordering McCrae, this exceptional 4-bedroom home is perfect for family living. With its spacious design and premium features, this residence is not just a house but a home waiting to welcome you!

Key Features:

- ? 4 Bedrooms: Spacious master with ensuite and walk-in robe, plus three additional bedrooms with built-in robes and ceiling fans.
- ? Living Areas: Enjoy two expansive living spaces equipped with split system air conditioners.
- ? Gourmet Kitchen: Entertain in style with a large breakfast bar, stainless steel appliances, 900mm oven, 5-burner stove top, and a walk-in pantry.
- ? Bathrooms: Two well-appointed bathrooms, including one

Price : \$1,090,000 - \$1,190,000
Land Size : 593 sqm
View : <https://www.ypa.com.au/8117106>



Michael Dimech
0417 399 511

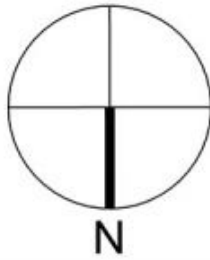

Internal area = 18.8 squares (approx)
 Alfresco area = 2.4 squares (approx)
 Garage area = 3.8 squares (approx)



Floor Plan

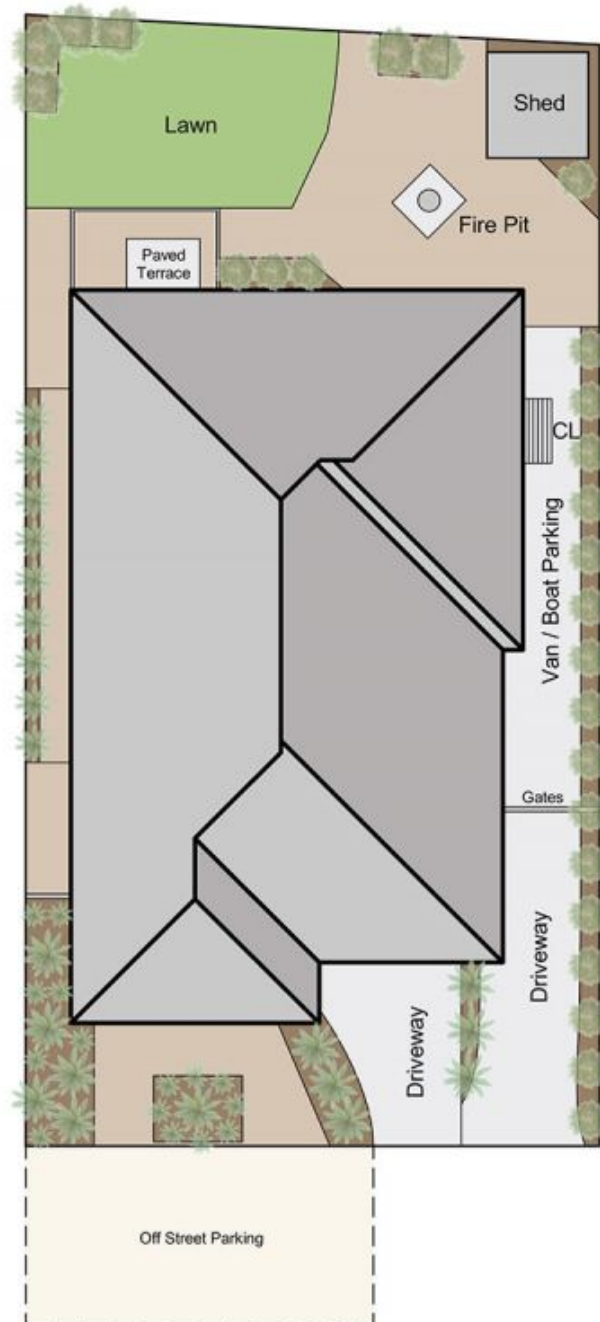

Site Plan

13 Sunningdale Road, Rosebud

This floorplan is for illustration purposes only and no warranty is given to its accuracy. Purchasers are advised to carry out their own investigations. Produced by **realitywriters** (03) 5970 2222