



**35 Osborne Avenue Gladstone Park VIC**

4  2  3 

Delivering an enviable location and ready for occupancy, this beautifully presented family home offers the perfect blend of convenience and comfort, ideal for families seeking a vibrant community lifestyle.

**Price** : \$ 780,000

**View** : <https://www.ypa.com.au/8125114>

With Gladstone Park at your doorstep, your life's necessities are all within walking distance with an array of local educational facilities, Gladstone Park Shopping Centre, public transport at your doorstep, together-with medical/remedial/dining/business precincts as well as nearby parklands with playground.

As you approach, you'll be greeted by the exquisitely manicured gardens that sets the tone for the elegance within. Captivating from the moment you step into this impeccably upheld and easily maintained home with its timeless archways entry and flooded with natural light.



**Michael Sassine**  
0421 023 243

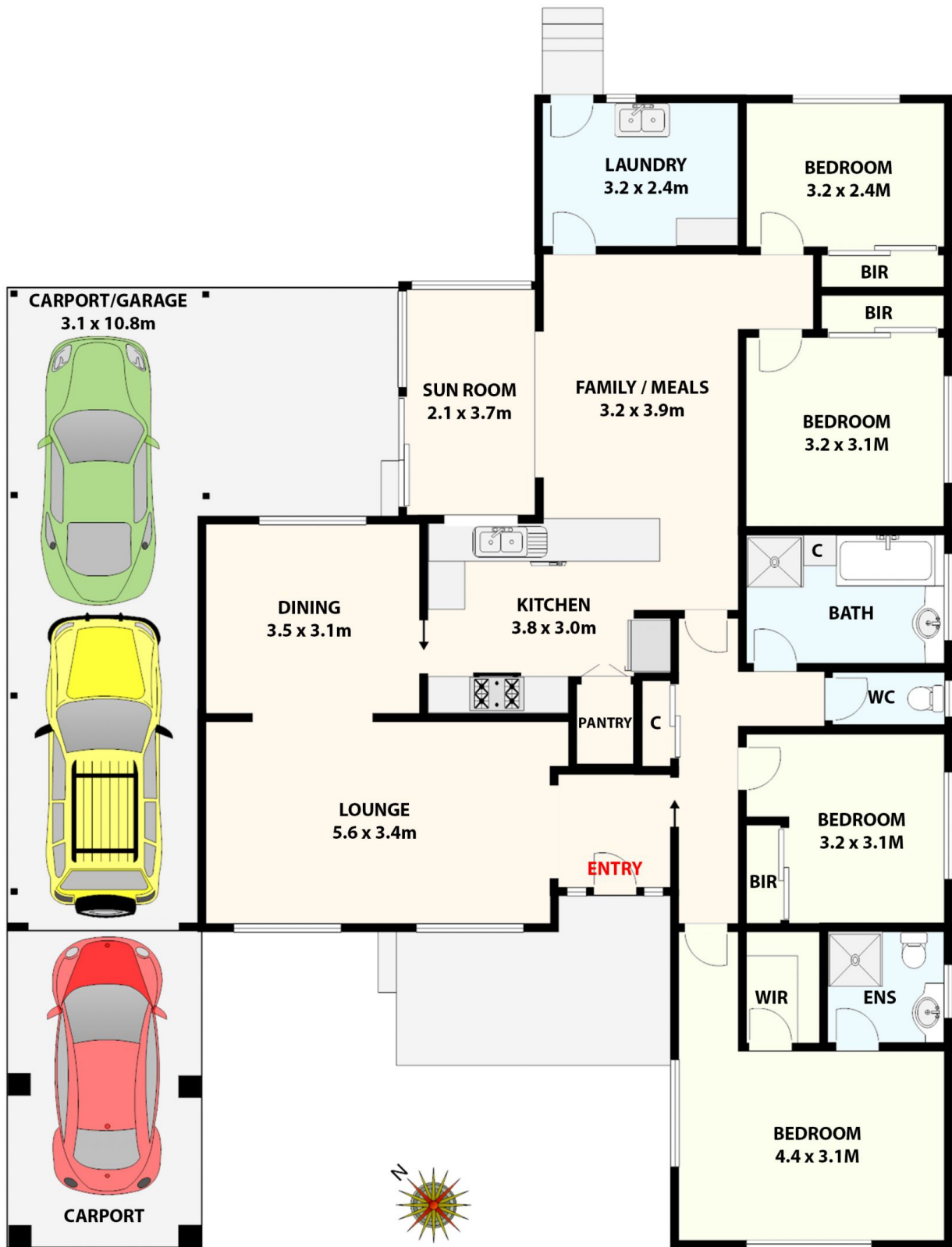

**35 Osborne Avenue, Gladstone Park.**  
*All data and dimensions shown in this sketch are approximate.*