



18 Elliotdale Walk Rockbank VIC

2 2 1

The team at YPA Melton are proud to present this fantastic opportunity to secure a quality brand new build, in the ever-growing Williams Walk estate in Rockbank. With multiple townhouses available for purchase, these properties provide an ideal location for any first home buyer, downsizer or savvy investor looking to enter the market.

Situated in the Williams Walk estate, with parklands, shops, schools, upcoming town centre, and public transport (including Rockbank Train Station) right at your doorstep, and right across from scenic wetlands, featuring walking tracks, this well thought out development has a estimated completion date by Christmas 2024 and offers everything you could wish for.

With these townhouses still under construction they provide

Price : \$449,000

View : <https://www.ypa.com.au/8128248>



Shane Spiteri
0488 980 115



Ricky Frew
0402 007 100

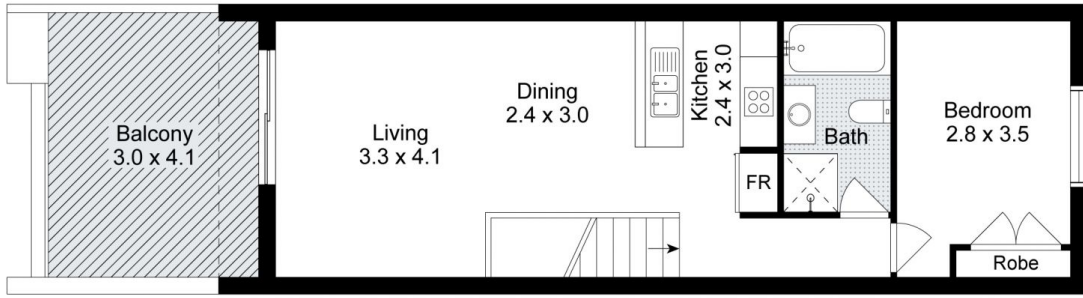

FIRST FLOOR

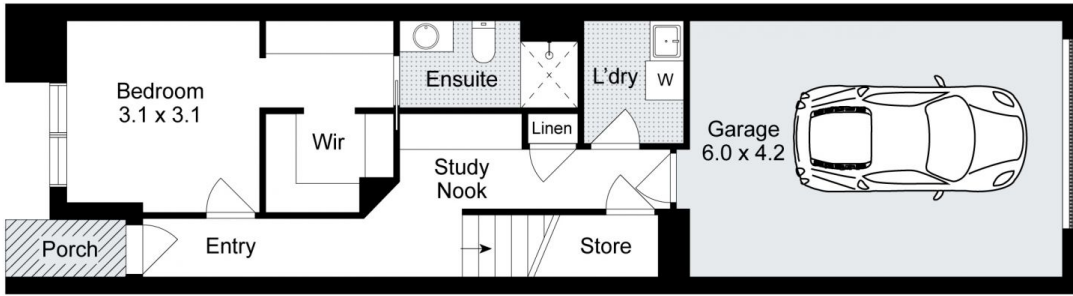

GROUND FLOOR

Whilst every attempt has been made to ensure the accuracy of the floor plan contained here, measurements of doors, windows, rooms and any other items are approximate and no responsibility is taken for any error, omission, or mis-statement. This plan is for illustrative purposes only and should be used as such by any prospective purchaser. The services, systems and appliances shown have not been tested and no guarantee as to their operability or efficiency can be given.