



1 Tern Court Melton VIC

3 1

Situated on a large 655m² (approx.), this property holds a perfect opportunity for all buyers. Located in a highly sought after pocket in Melton close by to all levels of schooling, childcare and preschool centres, parks, freeway access, and only a short distance to Woodgrove Shopping Centre, the positioning of this home is hard to beat.

Walking through the front door you are greeted with the large living area which provides ample space for the entire family. This is further accompanied by the meals area perfectly situated next to the kitchen, which features ample bench and cupboard space, stainless steel appliances, dishwasher and gas cooktop.

The three bedrooms located within the property are all generously sized and two feature built in robes creating enough space for the whole family, while all being serviced

Price : \$479,000 - \$499,000
Land Size : 655 sqm
View : <https://www.ypa.com.au/8141457>



Kate McGlone
 0401 853 244

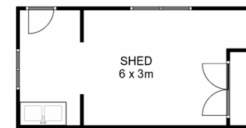

1 Tern Court, Melton

ypa

Whilst every attempt has been made to ensure the accuracy of the floor plan contained here, measurements of doors, windows, rooms and any other items are approximate and no responsibility is taken for any error, omission, or mis-statement. This plan is for illustrative purposes only and should be used as such by any prospective purchaser. The services, systems and appliances shown have not been tested and no guarantee as to their operability or efficiency can be given.

