



28 Regan Drive Romsey VIC

4  2  2 

Welcome to 28 Regan Drive, Romsey, where privacy, space, and country charm combine to offer the perfect family lifestyle. Set on a sprawling half-acre block, this beautifully maintained property is ideal for those seeking a peaceful escape in the heart of Romsey Township.

This generous family home features four well-proportioned bedrooms, all with built-in robes, including a master with an ensuite. The modern kitchen offers ample storage and bench space, seamlessly flowing into the multiple living areas, including a formal lounge for more intimate gatherings.

Comfort is guaranteed with ducted heating and evaporative cooling throughout, ensuring the home stays cozy in winter and cool in summer. With three separate outdoor living areas, you'll have plenty of space to relax or entertain, whether it's under the undercover alfresco or in the large backyard, perfect for kids and pets.

Price : \$755,000 - \$805,000
Land Size : 2158 sqm
View : <https://www.ypa.com.au/8145243>



Daniel Scarano
0448 735 298



Nic Owen
0422 107 177

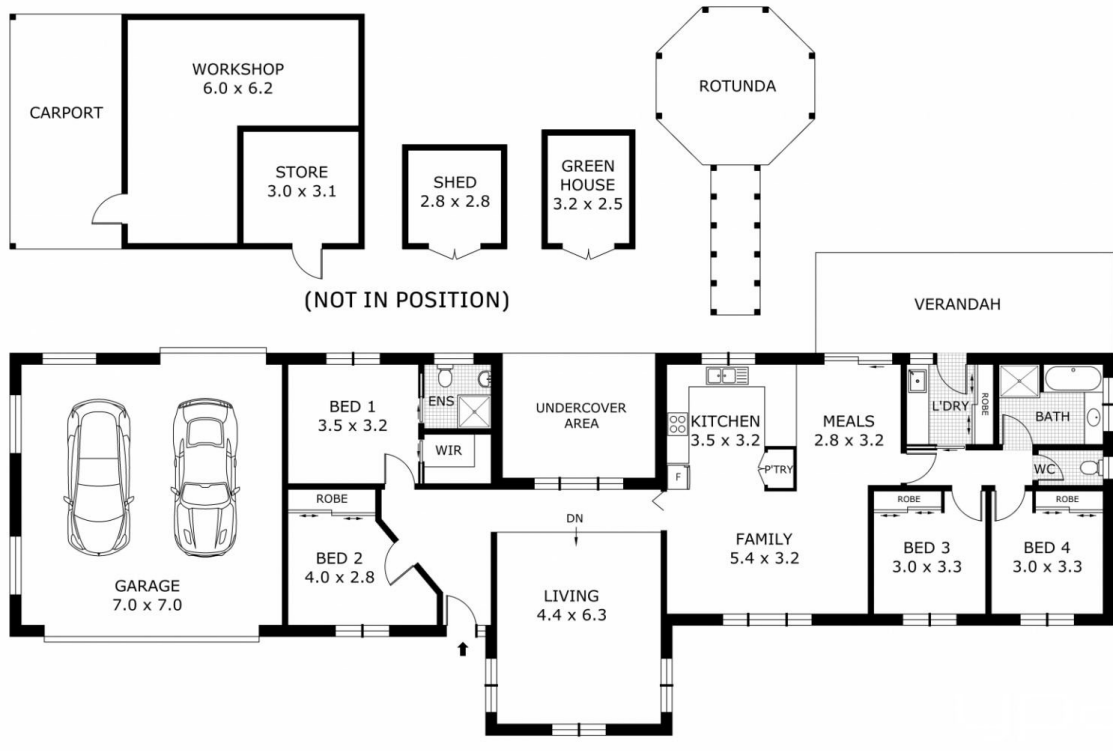

Disclaimer: All images, views and diagrams are indicative only. Dimensions, areas and landscape are indicative and subject to change without notice. Purchasers should check the plans and specifications included in the terms of the contract of sale carefully prior to signing the contract.