



1 Ramsay Close Pakenham VIC

5 3 13

Welcome to your dream home with the opportunity to securely store all your additional tools and vehicles. Nestled in the prestigious Heritage Springs Estate. This stunning property offers the perfect blend of luxury, space, and convenience, ideal for families looking for comfort and modern living.

Impressive Interior Features

Step through the entrance, and you'll be greeted by an expansive front living area that sets the tone for the elegance throughout the home. The formal living room provides a perfect space for entertaining, while the versatile layout includes a space for a home office that offers window views.

Price : \$1,259,000-\$1,379,000
Land Size : 895 sqm
View : <https://www.ypa.com.au/8153967>



Frances Cutri
0423485688

Vikram Chandel
0430 055 933

FLOOR PLAN



SITE PLAN

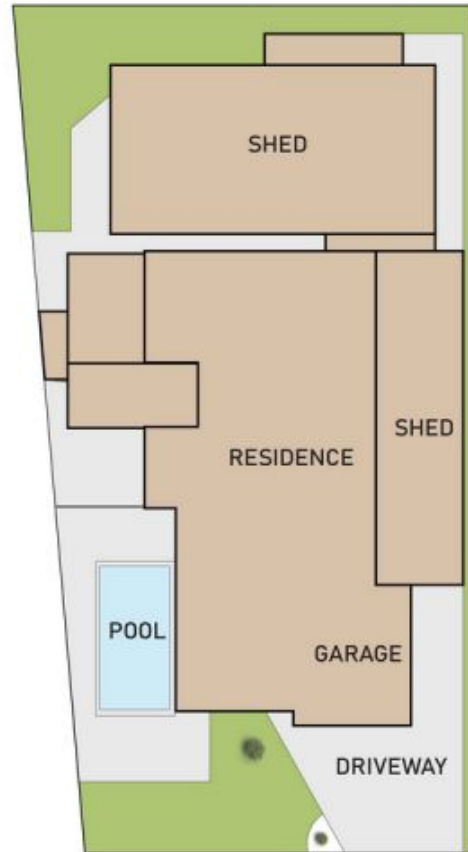

ypa

1 RAMSAY CLOSE, PAKENHAM

FLOOR AND SITE PLAN IS FOR ILLUSTRATIVE PURPOSES ONLY AND NOT TO SCALE. THE VENDOR, AGENCY OR SUPPLIER MAKE NO GUARANTEE, WARRANTY OR REPRESENTATION AS TO THE ACCURACY OF ANY INFORMATION CONTAINED HEREIN AND THE COMPLETENESS OF THE FLOOR PLANNED WILL ACCEPT NO LIABILITY FOR ITS ACCURACY. INTERESTED PARTIES ARE ADVISED TO MAKE THEIR OWN INDEPENDENT ENQUIRIES.

FLOOR PLAN



SITE PLAN

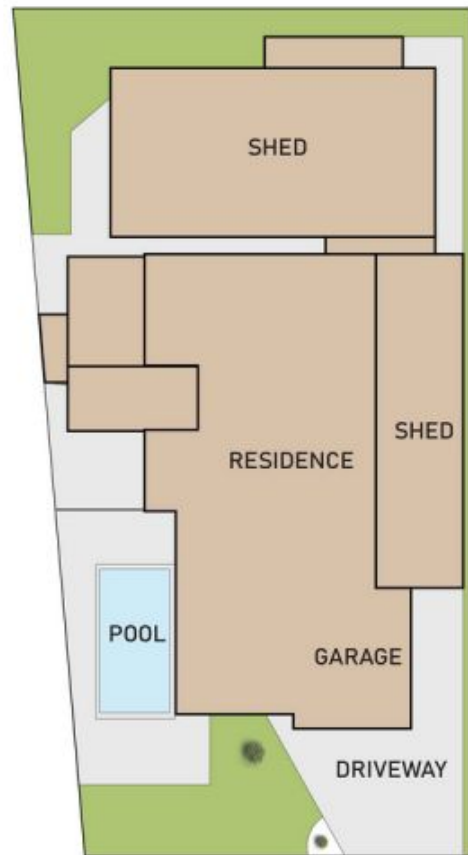

ypa

1 RAMSAY CLOSE, PAKENHAM

FLOOR AND SITE PLAN IS FOR ILLUSTRATIVE PURPOSES ONLY AND NOT TO SCALE. THE VENDOR, AGENCY OR SUPPLIER MAKE NO GUARANTEE, WARRANTY OR REPRESENTATION AS TO THE ACCURACY OF ANY INFORMATION CONTAINED HEREIN AND THE COMPLETENESS OF THE FLOOR PLANNED WILL ACCEPT NO LIABILITY FOR ITS ACCURACY. INTERESTED PARTIES ARE ADVISED TO MAKE THEIR OWN INDEPENDENT ENQUIRIES.