



92 Gallery Way Pakenham VIC

4 2 2

Nestled in the highly sought-after Arden Estate, 92 Gallery Way, Pakenham is the perfect family home, offering space, comfort, and modern conveniences. This beautifully designed four-bedroom residence is thoughtfully crafted to meet the needs of a growing family.

The master suite serves as a private retreat, featuring a spacious walk-in robe and a stylish ensuite. The remaining three bedrooms are generously sized, each equipped with built-in robes, ensuring ample storage space for all family members. At the heart of the home is the expansive open-plan living area, combining the kitchen, dining, and lounge into one seamless space. The modern kitchen is a chef's delight, complete with stainless steel appliances, including a dishwasher, oven, and cooktop, making meal preparation a breeze.

Price : \$699,000 - \$768,000
Land Size : 551 sqm
View : <https://www.ypa.com.au/8154335>



Frances Cutri
 0423 485 688



Rajiv Ranjan
 0413 775 214

FLOOR PLAN



SITE PLAN

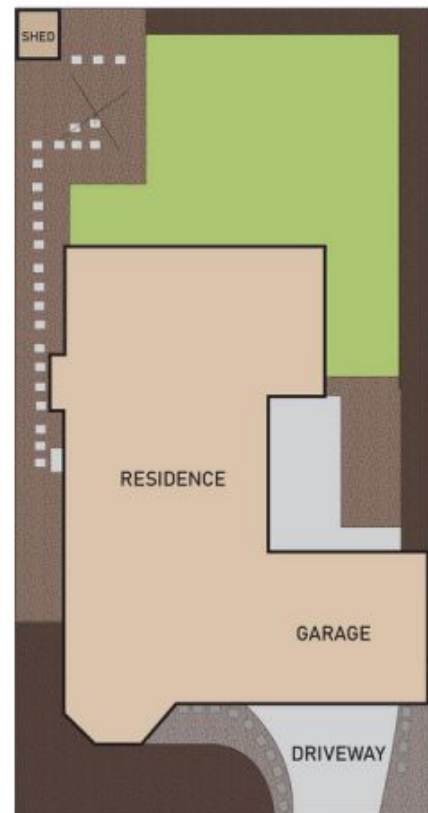

92 GALLERY WAY, PAKENHAM

upa

FLOOR AND SITE PLAN IS FOR ILLUSTRATIVE PURPOSES ONLY AND NOT TO SCALE. THE VENDOR, AGENCY OR SUPPLIER MAKE NO GUARANTEE, WARRANTY OR REPRESENTATION AS TO THE ACCURACY OF ANY INFORMATION CONTAINED HEREIN AND THE COMPLETENESS OF THE FLOOR PLANNED WILL ACCEPT NO LIABILITY FOR ITS ACCURACY. INTERESTED PARTIES ARE ADVISED TO MAKE THEIR OWN INDEPENDENT ENQUIRIES.