



## 16 Horseshoe Circuit Bacchus Marsh VIC

4 🚗 2 🚗 2 🚗

Positioned in the heart of Bacchus Marsh, approximately 450 metres from the Western Freeway Entrance and in close proximity to all local amenities such as schools, shopping precincts and public transport. This immaculately presented family home is filled with upgrades and quality fixtures throughout.

Upon first glance, the street appeal of this home is unmatched. From the exposed aggregate concreting, corner block with side gate access, beautifully manicured gardens to the incredible façade of the home.

Upon entering the home, you will be instantly impressed by the heightened 9-foot ceilings creating an instant feel of space, you are greeted with the first lounge room, fitted with floor to ceiling sheer blinds.

**Price** : \$649,000 - \$699,000  
**Land Size** : 523 sqm  
**View** : <https://www.ypa.com.au/8159232>



**Izabel Dusik**  
0421 833 010

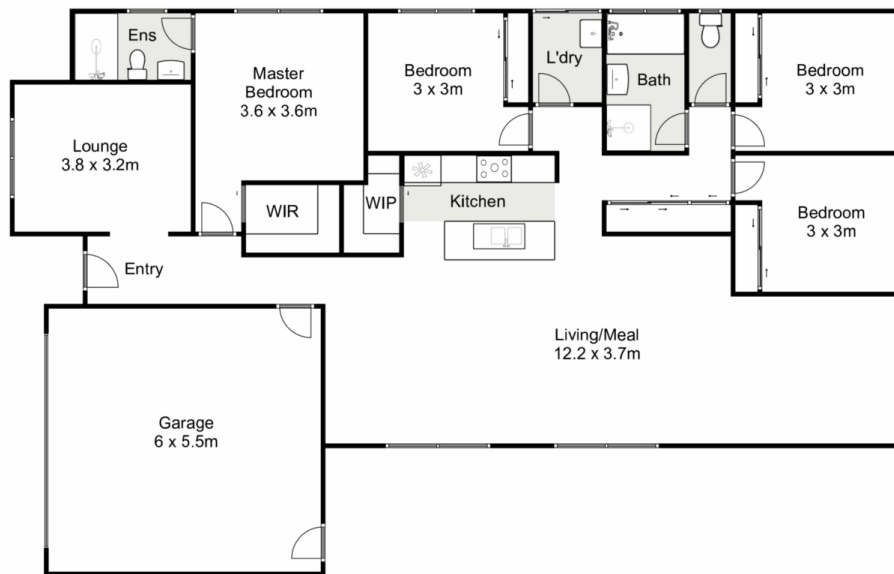

## 16 Horseshoe Circuit, Bacchus Marsh

Ypa

Whilst every attempt has been made to ensure the accuracy of the floor plan contained here, measurements of doors, windows, rooms and any other items are approximate and no responsibility is taken for any error, omission, or mis-statement. This plan is for illustrative purposes only and should be used as such by any prospective purchaser. The services, systems and appliances shown have not been tested and no guarantee as to their operability or efficiency can be given.

