



## 39 Almond Close Werribee VIC

3 2 2

A thoughtfully designed family home located in the sought-after Orchard Park Estate. Combining comfort, space, and modern design, this home offers everything a growing family could need.

**Price** : \$480 pw

**View** : <https://www.ypa.com.au/8162106>

### Why You'll Love This Home:

? **Spacious Bedrooms:** Three generous bedrooms, including a master with walk-in robe and ensuite, plus a private balcony overlooking lush parklands.

? **Multiple Living Zones:** Enjoy two large living areas and a separate study nook, perfect for family flexibility.

? **Gourmet Kitchen:** The light-filled kitchen boasts stainless steel appliances, a walk-in pantry, and sleek cabinetry for ample storage.

? **Outdoor Appeal:** A low-maintenance backyard with tree-lined views offers a private, relaxing space for outdoor



**Ali Dowling**  
0450 778 972

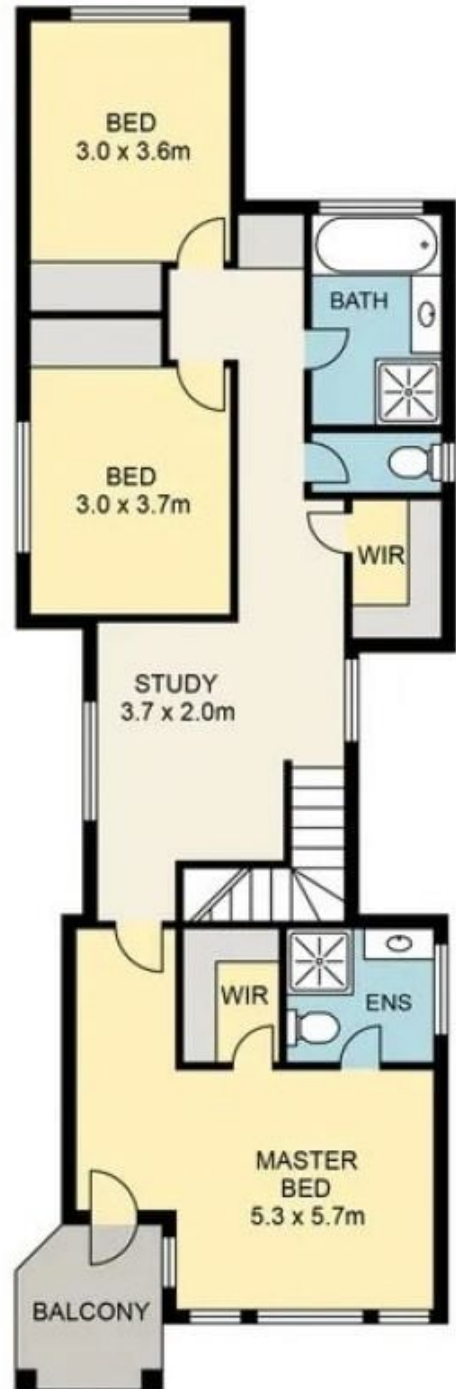

## 39 ALMOND CLOSE, WERRIBEE

**DISCLAIMER**

PLANS SHOWN ARE FOR MARKETING PURPOSES ONLY. ALL DIMENSIONS ARE APPROXIMATE AND NOT TO SCALE. THEY ARE SUBJECT TO ERRORS AND INACCURACIES AND NO LIABILITY WILL BE ACCEPTED. INTERESTED PARTIES SHOULD MAKE THEIR OWN INQUIRIES.