



## 13 Lang Road Melton South VIC

3 1 2

Situated on fantastic block of 590m<sup>2</sup> (approx.), this exceptional property located in Melton South is close by to all amenities including: Melton train station, shops, all levels of schooling and so much more, this property is the perfect opportunity for all buyers entering the property market and investors alike.

Comprising of three generously sized bedrooms, all with built in wardrobes and a central bathroom.

The living area offers plenty of space for the growing family, this leads through to the dining area which is overseen by the kitchen.

Moving outside the well maintained backyard offers a single car lockup garage and an additional carport behind double gates. Further complimented by an additional

**Price** : \$439,000 - \$479,000  
**Land Size** : 590 sqm  
**View** : <https://www.ypa.com.au/8164972>



**Mark Edwards**  
**0422 017 068**

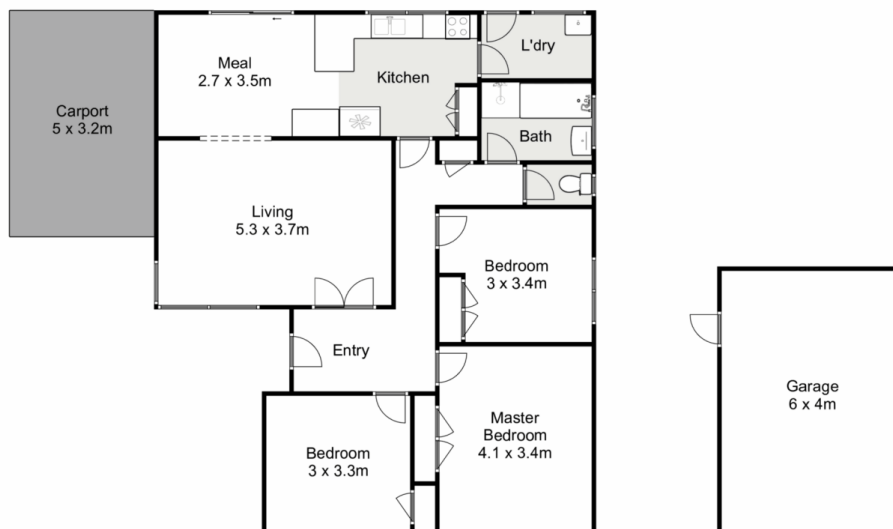

## 13 Lang Road, Melton South

ypa

Whilst every attempt has been made to ensure the accuracy of the floor plan contained here, measurements of doors, windows, rooms and any other items are approximate and no responsibility is taken for any error, omission, or mis-statement. This plan is for illustrative purposes only and should be used as such by any prospective purchaser. The services, systems and appliances shown have not been tested and no guarantee as to their operability or efficiency can be given.

