



## 14 Eastfield Road Ringwood East VIC

4 2 2

Calling all tradies, home renovators, or those looking for a new home site -unlock the potential of this four-bedroom home situated on a 683\*m2 block close to local amenities.

While the home is currently not habitable and requires significant renovations-including the replacement of the main structural beam, roof, and plaster on some of the internal walls - the true value lies in the prime land. This property is a renovator's dream, offering ample space and an ideal location for those looking to create their perfect family home or explore development opportunities (subject to council approval).

Located just moments from Maroondah hospital, Eastland and nestled within the highly sought-after Ringwood Secondary School zone, this property provides a fantastic opportunity for families and investors alike.

**Price** : \$760,000 - \$800,000  
**Land Size** : 683 sqm  
**View** : <https://www.ypa.com.au/8171872>



**Tony Talarico**  
0420 778 401



**Katrina Talarico**  
0420 778 404

Internal living area  
approx: 12 squares

Decking area  
approx: 2 squares

Total area  
approx: 14 squares

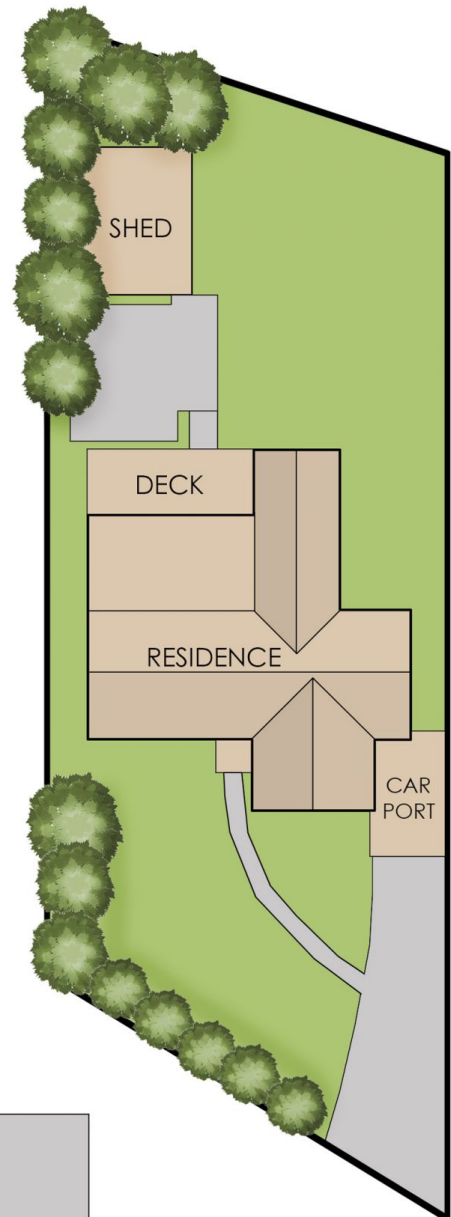

## 14 Eastfield Road, Ringwood East

© Produced by DND Floor Plans

This floorplan is for illustration purposes only and no warranty is given to its accuracy. Purchasers are advised to carry out their own investigations.